

# HOUSING AND RESIDENCE LIFE INFORMATION



SlipperyRock  
University<sup>SM</sup>  
of Pennsylvania



# WELCOME TO HOUSING AND RESIDENCE LIFE

We hope you are excited and eager about the challenges and experiences that await you for the upcoming year. Our housing and residence life staff is committed to helping you be successful as a student and in helping you connect with the University community so your home-away from-home is safe, clean, well maintained and comfortable. Housing and residence life prides itself on our programming initiatives and collaboration with other University offices to provide each student with a unique and individualized residence hall experience.

The mission of the staff in housing and residence life is to provide a residential environment that supports and encourages every student to be a responsible global citizen, become a lifelong learner and to develop personally.

Please read the following pages carefully as we have attempted to answer as many questions as possible. At the end of this brochure, you will find the instructions for submitting your residence hall agreement and preferences. Please also note that **as a first-year student you will most likely be residing in a double occupancy residential suite room or a traditional double.** The Office of Housing and Residence Life cannot guarantee any specific room or building type.



## CONTENTS:

- Residence Halls Provide ..... 4
- Introduction to the Traditional Halls..... 5
- Introduction to the Residential Suites..... 6
- Living-Learning Communities..... 8
- Lifelong Learning Experiences ..... 10
- Things You Need to Know/Roommate Information ..... 13
- SRU Housing Application Process..... 14



# SRU RESIDENCE HALLS PROVIDE:

- A safe, secure, comfortable living and learning environment.
- 24-hour desk attendant coverage with overnight coverage at every building's front desk including assistance with guest registration, printing services for academic work, checking out hall equipment and lock outs.
- Live-in staff available for answering questions, mediating conflicts, as well as establishing social and educational programs encouraging community development.
- Housing and Residence Life will provide students with the opportunity to engage with outside departments such as the Center for Student Involvement and Leadership (CSIL), Women's Center, Hope Peer Educators and the Office for Inclusive Excellence to gain valuable extra-curricular experiences and meaningful relationships.
- Sprinkler systems and smoke detectors that cover both common areas and individual living areas in every building.
- Convenient laundry facilities located in each building, students can now pay with a cellphone by loading funds onto Clean Cash app, or with coin.
- Close to classes, library, offices, food options, ARC and Robert M. Smith Student Center.
- Access to SRU maintenance staff from the Web to report room or hall maintenance requests.
- University and contracted staff provide daily and emergency maintenance and custodial services to all residence halls and residential suites. In traditional residence halls, the custodial staff cleans all common areas and community bathrooms on student floors. In the residential suites, the custodial staff provides services to common areas within the halls.

“I really like being in the center of everything and all of my friends are here.”



**Rhoads Hall Double Occupancy Room**  
Anticipated cost per semester: \$1,744



## Our Traditional Residence Halls...

Traditional-style residence halls at SRU provide a living environment to students interested in a traditional college housing structure - double occupancy rooms. The greatest asset these buildings offer is the opportunity to know others in the community. It is not unusual to find students grouped together studying, playing video games, sharing a pizza or just hanging out talking about their day.

Both Rhoads and North Hall share their building with University offices on the first floors. Rhoads Hall also serves as the home to the Student Health Center and the Counseling Center. Most recognized for its rounded front entrance, Rhoads Hall is conveniently located between North and Patterson Halls, a short walk from the center of campus.

The first floor of North Hall is home to the University's Admissions and Enrollment Services Offices. Originally built in 1938, this Georgian-style building stands near Old Main and is one of the campus' signature buildings.

**North Hall Double Occupancy Room**  
Anticipated cost per semester: \$1,744

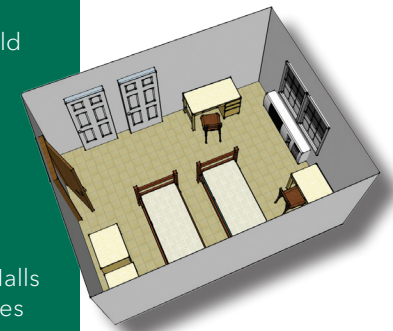

## Amenities include:

- A fully furnished living environment
- Recreation room and vending areas
- Card access
- 100 percent wireless access in all of the Residence Halls and each student can use up to five electronic devices for free under their personal ResNet account.
- Air conditioning
- Elevators
- Convenient to downtown Slippery Rock
- In-hall mailroom

PLEASE NOTE: If you indicate your residence hall preference as "traditional" on your application, you may be placed in any of these room types. Choosing "traditional" is only a preference and is not a guarantee. If you need traditional housing as an option please apply by March 1.



**Double Studio**  
Anticipated cost  
per semester: \$3,510

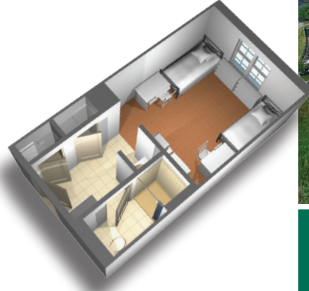

**Double Suite**  
Anticipated cost  
per semester: \$3,900



“I really love living in the residence halls because they really helped my transition into college life and now I feel like I am a part of a new family.”



## Our Residential Suites...

The Residential Suites are known for their exclusive living accommodations, including state-of-the-art wireless internet access and the newly improved student laundry facilities located in all of the Residence Halls. Living in the suites fosters student independence while creating life-long friendships. Our community assistants and staff try to enhance each student's academic experience with creative programming initiatives. These buildings also employ an apartment-style feel without moving off-campus. We have staff available on each floor section to assist students with their transition. All of our buildings are LEED certified and equipped with energy-efficient heating and cooling systems. All of the residence halls are highly secured and equipped with motion-sensor lighting systems and automatic door locks. The room types you see on the left of this page are two examples of rooms that most first year students are assigned to. The room types listed are not guaranteed. Please note, that first year students could possibly be assigned to any room types we have in our residence halls. If you have a specific request, please call our main office line at **724.738.2082** or email [mimi.campbell@sru.edu](mailto:mimi.campbell@sru.edu). Requests are not a guarantee and are based on availability at the time of application.

### Amenities include:

- A fully furnished living environment
- Semi-private bathrooms
- 100 percent wireless access in all of the Residence Halls and each student can register up to 8 electronic devices for free under their personal ResNet account.
- Snack prep area with microwave and refrigerator
- Individual air conditioning and heat controls
- Suites with a common area also have cabinets, sofa, chairs and end tables

**Please note what type of housing you are most interested in (suite vs. traditional).**

## SRU ON-CAMPUS NETWORKING AND WIRELESS ACCESSIBILITY:

In our residence halls, we pride ourselves on our state-of-the-art computer networking services for all of our on-campus students. This service allows students to have 100% wireless access in all of our residence halls. The quick internet accessibility will also follow students across campus including the academic classroom buildings. Students can use up to 8 devices for free, with the ResNet wireless service. First year students must create their MyResNet account and register their devices before arriving for the academic year. This will ensure that each student will be ready to use the service once they arrive to campus. If students want to register more devices or increase the speed of the service they also have the option to purchase other packages for a minimal cost.



“Incoming students should really look forward to the way the residence halls get you involved. There is always something to do when you live in a residence hall. Whether it's a program or just visiting a friend down the hall.”



# LIVING-LEARNING COMMUNITIES AT SRU

Living with people that have a similar major makes finding study groups so much easier.

Living-Learning Communities offer the opportunity to live and learn with other students who share their academic, professional and personal interests. The LLCs are one of many ways to help our students achieve. Students who live in these communities have higher GPAs than those who do not.

Research supports LLCs, stating that "...students who are successful academically and engaged socially are more likely to persist and graduate." - Vincent Tinto, Ph.D., Syracuse University

### Specialty space:

Most residence halls that house an LLC have a meeting room with resources just for the LLC students.



Locations of LLCs may be subject to change.

LLC	Description	Location
Business	For students who are majoring or minoring in College of Business degree programs. <b><a href="http://www.sru.edu/academics/colleges-and-departments/cob">http://www.sru.edu/academics/colleges-and-departments/cob</a></b> Majors include: advertising, communication studies, digital media production, integrated marketing communication, journalism, public relations, resort recreation and hospitality management, safety management, sport management, accounting, economics, finance, information systems, health care administration and management, management, marketing.	Building D (select floors)
Education	For students who are majoring or minoring in College of Education degree programs. <b><a href="http://www.sru.edu/academics/colleges-and-departments/coe">http://www.sru.edu/academics/colleges-and-departments/coe</a></b> Majors include: early childhood education, health and physical teacher education, physical activity and fitness management, middle level education, secondary education.	Watson Hall
Health, Engineering and Science  Health Professions	For students who are majoring or minoring in College of Health, Engineering and Science or the Health Professions degree programs. <b><a href="http://www.sru.edu/academics/colleges-and-departments/ches">http://www.sru.edu/academics/colleges-and-departments/ches</a></b> Majors include: biology, chemistry, computer science, exercise science, athletic training, geography, geology, environmental science, mathematics, statistics, nursing, park and resource management, environmental education, physics, engineering, psychology, public health, social work, and recreational therapy.	Building A
Honors	For students who are enrolled in the SRU Honors College. Applications will be reviewed by the associate director of Residence Life. <b><a href="http://www.sru.edu/academics/honors-program">http://www.sru.edu/academics/honors-program</a></b>	Watson Hall
Liberal Arts	For students who are majoring or minoring in College of Liberal Arts degree programs. <b><a href="http://www.sru.edu/academics/colleges-and-departments/cla">http://www.sru.edu/academics/colleges-and-departments/cla</a></b> Majors include: art, fine art, criminology and criminal justice, dance, language and literature, creative writing, professional writing, English education, history, corporate security, homeland security, anthropology, cultural area studies, cognitive science, gender and diversity studies, leadership studies, philanthropy and nonprofit management, sociology, french, spanish, music, philosophy, political science, theatre.	Building D (select floors)
ROCK Athletics	In this LLC, students may be paired with SRU athletes or students who have a particular interest in sports in order to make connections with others in their relation to their passion for, experience in, or career-preparedness regarding student athletes and athletics.  Majors which fit well with this LLC include: Biology, Exercise Science, Health and Physical Education, School Wellness Education, Physical Activity & Fitness Management, Sport Management, Adventure Fitness (minor), and/or Coaching (minor). Pre-Physical Therapy, Pre-Physician Assistant, Pre-Occupational Therapy and current or previous athletes.  Must apply through housing application to be considered.	Building B (select floors)
ROCK Life	Rock Life is an inclusive 4-year, non-degree bearing program for students with documented intellectual disabilities, degree seeking students may reside on this wing too. Students pursuing majors in special education, transition programming and recreational therapy are invited to apply.	Watson Hall

## Lifelong Learning Experiences

Living in the residence halls will be your first step in lifelong learning. It will be very different from living at home with your parent(s) or guardian(s). Keep in mind your roommate might be very different from your religion, culture, color, race, sexual orientation, have differing political beliefs, study behaviors and sleeping patterns. At Slippery Rock University, we value the diversity of our students and encourage a community of respect and understanding. We are a caring community of learners, which means we expect our students to have an open mind when experiencing new things. We believe learning occurs both in and out of the classroom, and the experience of living with diverse students in the residence halls provides an educational opportunity. We also believe that this learning occurs in each of our Residential Suites and Traditional Hall environments. We hope each student, no matter where you are living, has the opportunity to create and enhance valued multicultural experiences.



Programs and activities offered within Housing and Residence Life that focus on the values of personal development, global citizenship and lifelong learning:

- Living-Learning Communities
- ARHS, NRHH and House Councils
- Floor and hall socials and events
- Service projects
- Many other campus collaborations

## Community Life in the Residence Halls

Each Community Assistant is responsible for creative programming initiatives to enhance the student experience. Housing and Residence Life has set forth a unique programming model for our staff to follow. We understand that each of our students' personalities and needs can be very different. We value the differences that the students bring to our communities; therefore, our staff is committed to assessing the needs of each individual to enhance their Slippery Rock University Experience. Housing and Residence Life Programming operates from our strategic plan which is based around our student assessment initiatives. Our community assistant staff is required to plan 3 programs a month for each floor section; we like to keep each student engaged in the residence hall environment.





Incoming students can look forward to making new and everlasting friendships, while also forming their own individuality.



## As a first-year student, please be aware of the following:

- Expect to have a roommate.
- We have many different room types available; if you are looking for a particular room, due to cost or preference, then you should complete your housing application ASAP and no later than March 1. After this date, we are not able to make any promises on room type and availability of space.
- If you are planning to commute from your permanent home address, please submit a notarized letter to our office via an exemption request on the My Housing Portal under applications by July 1. Otherwise, all first-year students must live on campus. This is University policy.
- Housing agreements are for the entire academic year.
- You may check your housing assignment in your MyHousing Portal (<https://reslife.sru.edu>). Your intended roommate(s) name and SRU email address will be found here as well.
- LLCs occupy a portion of each building (with the exception of Building A which is all HES). There is no additional cost associated with living in one of these communities. If you apply to an LLC and your major matches the college, you will be automatically accepted.
- Gender-inclusive housing is available. Contact Housing for information.
- If you do not have access to the Internet, please call our office at 724.738.2082 and we will mail you application materials.



## Roommate Information

- Roommate requests must be mutual and take precedence over all other preferences, including room style and LLC requests (if applicable).
- If you or your roommate are applying for an LLC, you must be aware that both roommates must apply to and be accepted in the same LLC or the LLC request cannot be honored.
- When making your roommate request, **you will only be able to choose from students who have already signed their agreement and paid their housing fee.** Names will be found in the drop down box. If you do not see the student you would like to request in the drop down box, it means they have not yet paid their fee or signed their agreement, have a placement already, or are in an LLC which is different than yours.

# SUBMITTING YOUR HOUSING MATERIALS AND REQUESTS

While step-by-step instructions can be found on the Housing and Residence Life webpage at <https://www.sru.edu/housing>, basic instructions appear below.

## PHASE 1:

**Prior to completing your housing application, you will need:**

1. A credit card or banking information for an electronic check for the \$175 advance housing fee. This is non-refundable after May 1.
2. Date of meningitis vaccination. This information is required. Your vaccination date can be obtained from your physician or your high school records. A waiver can be electronically requested when vaccination is medically contraindicated.
3. Slippery Rock University's primary form of communication will be via your SRU email account. Please log in frequently, or forward your University email to another personal account, to be sure you receive correspondence. All first-year students are required to live on campus at Slippery Rock University for 2 years. (You will sign another contract for 2024-2025). Students must complete a housing application or apply for an exemption (both in your MyHousing Portal). If you do neither, you will automatically be assigned housing prior to the fall semester starting. Requests for exemptions will be reviewed every 2 weeks by a committee. More details may be found at [www.sru.edu/residencerequirement](http://www.sru.edu/residencerequirement)

## STEP 1:

**Sign the Housing Agreement**

- Log into MyHousing Portal: <https://reslife.sru.edu>
  - Username: Your SRU ID.
  - Password: Your password is the same one you use to check your SRU email, or if you have never logged in before, it is your six-digit birth date (mm/dd/yySru).
- Select "Application/Agreement" on the menu.
- Select the Fall 2023 agreement.
- **READ THE AGREEMENT CAREFULLY; THIS IS A LEGALLY BINDING CONTRACT FOR THE ENTIRE ACADEMIC YEAR (TWO SEMESTERS).**
- Sign the agreement electronically. This will serve as your signature for the 2023-2024 academic year. Click "continue."

- **NOTE: Students residing on-campus are required to obtain a meal plan. The University will automatically invoice you for weekly 14 meal plan as outlined in your housing agreement. You may log back in to your MyHousing portal to change your meal plan after July 1st. Please visit <http://www.sru.edu/dining> or contact Dining Services for more specific details at 724.738.2038. The meal plan may be adjusted one time until a designated date in September.**

## STEP 2:

**Complete the "My Information" Section**

- Students requesting specific housing due to medical issues must be registered with the Office of Disability Services. The Office of Housing and Residence Life cannot accommodate requests to medical concerns unless you are registered with the Office of Disability Services.
- Students residing in residence halls are required to have received the meningococcal vaccination. Please provide the date you received the vaccination or waive the vaccination
- You will have the option to give a preference on campus area (Residential Suites, Buildings A-F or Traditional Halls, North and Rhoads). This is only a request and cannot be guaranteed.
- You will have the option to give a Living Learning Community (LLC) preference (pages 8-9).
- Please note: If you select to live in an LLC and your major matches the LLC requirement, you will be automatically approved. Honors & Rock Athletics are reviewed by Housing Staff.
- If you or your roommate are applying for an LLC, you must be aware that both roommates must apply to the LLC - and approved - or the request cannot be honored.
- After you had selected your preferences, click "Continue."

## STEP 3:

**Complete your Addresses/Contacts.**

- Please complete Parental Verification contact. This is required. Your parents will receive a verification code sent to their email address. They will then need to log into the housing portal (as you) and enter the code. If they do not receive an email with the verification code, make sure to check in the spam or junk folder. If it does not arrive, please call our office for assistance. 724.738.2082.

## STEP 4:

**Complete your Living Requests (Optional)**

- You may enter additional preference here. This is only optional and will be used if you didn't select your room during room selections.
- After you had selected your preferences, click "Continue."

## STEP 5:

**Pay Housing Fee**

- Submit the housing fee. This step is not optional and without the fee, your application will not be processed. If you are unable to pay the \$175, please contact the Housing Office for assistance.
- After you have completed both the agreement and submitted payment, you will be directed to sign your meal contract. Changes to your dining plan may be made at the beginning of July via the MyHousing Portal. You will receive an email via your SRU email account confirming that you have completed Step 1.
- If the student is under 18 years of age, a verification email will be sent to the parent email entered in the "Addresses/Contacts" section.
- Click Home.

## PHASE 2:

**Choosing a roommate or suitemates**

Students may place an ad for a roommate or roommates in their housing portal. You may include your social media ID as a way to connect with potential roommates.

**Roommate/Suitemate Request (Optional)**

- If a student has already been assigned a room or has not been admitted to the University, you will not be able to request them.
- Roommate/suitemate requests will take preference over all other personal preferences. Your requested roommate/suitemate must also list you on their request.
- Roommate requests are limited to no more than 3 other students and must be mutual. Roommate/suitemate requests will take preference over all other personal preferences. Your requested roommate/suitemate must also list you on their request.
- Using MyHousing Portal, under the Room Selection menu, click "Roommates/Suitemates."
- Select the fall 2023 term and click Submit.
- Enter the search information.
- Your intended roommate's name should appear. Please be sure you are spelling their name correctly. If you do not have a roommate in mind, you may still select your room type and Housing will fill in the room.

## PHASE 3:

**Choose your room**

- **MARCH:** Students who have completed their housing application prior to Feb. 28 may select their own room during the month of March. Students may also select their roommate(s) at this time if their intended roommates have done the same.
- **APRIL:** Students who apply for housing after Feb. 28 but before March 31 may select their room/roommates the first week in April.

**Students who apply for housing on or after April 1 or have not selected their room will have their housing placement done for them by the Housing staff.**

Please check your SRU email regularly for notifications.

Housing & Residence Life strives to make sure all students have their housing placement finalized prior to attending orientation.

**For more information visit us online or call 724.738.2082.**



**For more information about housing please contact  
the Office of Housing and Residence Life**

**Phone: 724.738.2082**

**Fax: 724.738.2917**

**[www.sru.edu/residencelife](http://www.sru.edu/residencelife)**



Slippy Rock University is committed to a policy of affirmative action. Slippy Rock University assures an equal opportunity to all persons without regard to race, color, religion, creed, disability, ancestry, national origin, age, gender or veteran's status in accordance with the state and federal laws, including Title VI of the Civil Rights Act of 1964, Title IX of the Education Amendments of 1972 and Section 504 of the Rehabilitation Act of 1973.

**[www.SRU.edu](http://www.SRU.edu)**

**SlippyRock**  
University<sup>SM</sup>  
of Pennsylvania

**Experience the Difference**

**Office of Housing  
and Residence Life**

105 Watson Hall  
102 Rock Pride Drive  
Slippy Rock, PA 16057

A member of Pennsylvania's State System of Higher Education